

SECTION A-A

PANEL CUT-OUT
Thickness 3.0mm Max

Material&SPEC

- 1.Shell Material:PPD,PA66 UL94V-0
- 2.Insulation Materials:PPS, High Temperature 260°C
- 3.Contact:Brass,Gold-Plated
- 4.Insulation Resistance:2000MΩ
- 5.Number Of Poles:2~12 Poles
- 6.Coupling:Threaded
- 7.Termination:Solder
- 8.IP Rating:IP68
- 9.Durability:500 Mating Cycles
- 10.Temperature Range:-25°C~+80°C

ORDER INFORMATION:

RHTOY21 A2-XX

IP68 Connector Type
Female Socket for Panel Mount
Number Of Poles, 2~12 Poles

Solder Contact Arrangement And Spec

Number Of Contact	2	3	4	5A	5B	5C	7	9	12
Male Contact Face View									
Rated Current (A)	30A	30A	30A	30A	30A/5A	15A	15A	5A	5A
Contact Diameter	∅2.8x2	∅2.8x3	∅2.8x4	∅2.8x5	∅2.8x2 ∅1.0x3	∅1.8x5	∅1.8x7	∅1.0x9	∅1.0x12
Rated Voltage (AC.V)	500V	500V	500V	500V	500V	500V	500V	500V	400V
Test voltage (AC.V)mm	1500V	1500V	1500V	1500V	1500V	1500V	1500V	1500V	1200V
Contact Resistance mΩ	1	1	1	1	5, 1	2.5	2.5	5	5
Wire Size Soldermm ² /AWG	≤4.17/11	≤4.17/11	≤4.17/11	≤4.17/11	≤4.17/11 ≤0.785/18	≤2/14	≤2/14	≤0.785/18	≤0.785/18

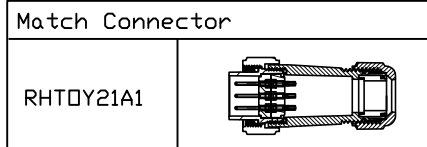
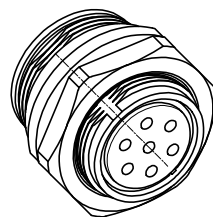

RHTECP NINGBO RHT ELECTRONIC CO.,LTD

UNITS:mm SHEET SIZE: A4 SCALE:---
0~3 3~18 18~50 50~120
±0.12 ±0.15 ±0.3 ±0.5

DRWN BY PAN
CHK'D BY FENG
APPR BY ZHAN

W21 CONN,Solder,Female Socket for Panel Mount,IP68

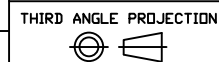

RHTOY21A2-XX