

# SPECIFICATIONS

Rating: 0.3A 50VDC

Contact Resistance: 50MΩ max

Insulation Resistance: 500VDC 100MΩ Min

Dielectric Strength: 100V AC 1 Minute

Operating Force: 100gf~800gf

Electrical Life :10,000 cycles

# ORDER INFORMATION

RHTGYS31 -2 2 F 03 - X X -X

Slide Switch Type

Pole

Throw

Travelling					
C	D	E	F	G	H
1.5	2.0	2.5	3.0	3.5	4.0
I	J	K	L	N	P
4.5	5.0	5.5	6.0	7.0	8.0

Sequential No.

Knob Type

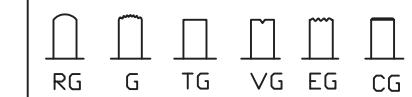

Knobe Height

Operating Force

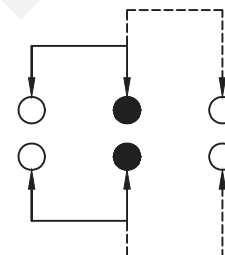
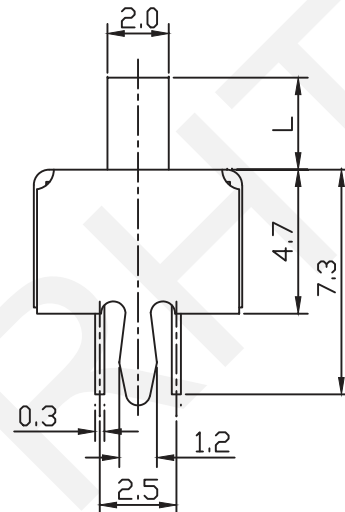
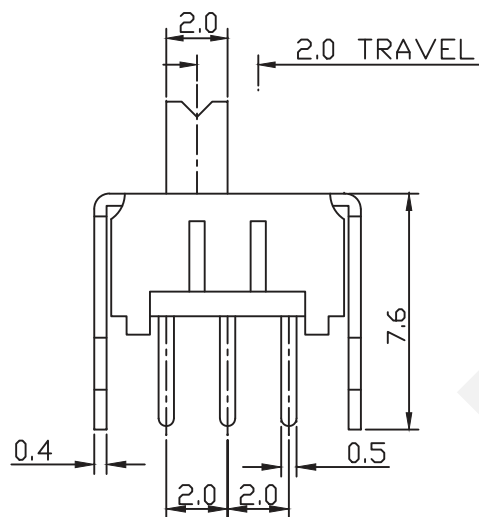

SCHEMATIC

RHTECP® NINGBO RHT ELECTRONIC CO.,LTD

UNITS:mm

SHEET SIZE: A4

SCALE:---

DRWN BY PAN

Slide Switch Series

0~3

3~18

18~50

50~120

CHK'D BY FENG

THIRD ANGLE PROJECTION

RHTGYS31-22D03-XX-X

±0.12

±0.15

±0.3

±0.5

APPR BY ZHAN



1

2

3

4

5

6

7

8

9