

Ø3.50mm 3 POLE PLUG

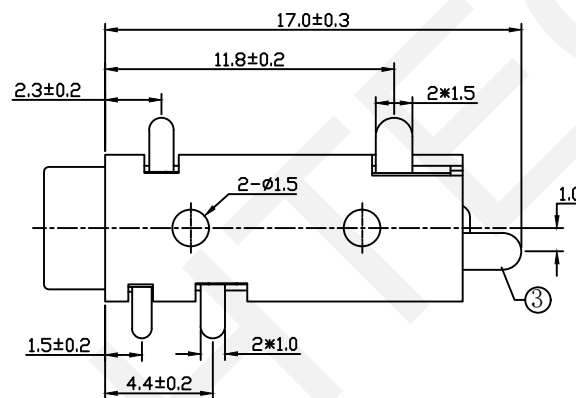

SCHEMATIC

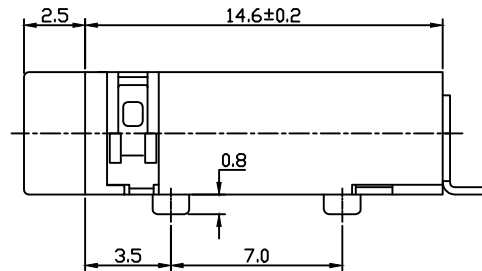
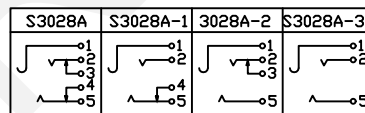

P.C.B LAYOUT
TOP VIEW

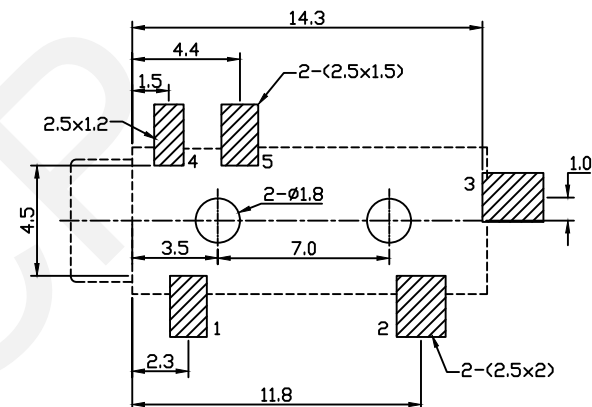

SPECIFICATION

- 1.Rating : DC 30V 1.0A;
- 2.Contact resistance : ≤0.03Ω;
- 3.Insulation resistance : ≥100MΩ (DC250V);
- 4.Withstand voltage : 500VAC ;
- 5.Insertion and extraction force : 3-20N;
- 6.life test : 5,000 cycles *

| | | | | |
|-----|-----------------|-----|----------|------------|
| 6 | HOUSING | 1 | PA9T | |
| 5 | 5# CONTACT FOOT | 1 | SUS301 | Ag-Plating |
| 4 | 4# CONTACT FOOT | 1 | BRONZE | Ag-Plating |
| 3 | 3# CONTACT FOOT | 1 | BRASS | Ag-Plating |
| 2 | 2# CONTACT FOOT | 1 | BRONZE | Ag-Plating |
| 1 | 1# CONTACT FOOT | 1 | SUS301 | Ag-Plating |
| NO. | DESCRIPTION | QTY | MATERIAL | PLATING |

