

RoHS Compliance

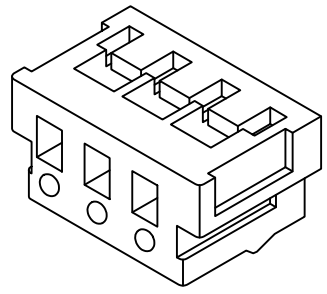

Pin	Dimension(mm)		
	A	B	C
02	2.00	---	6.00
03	4.00	---	8.00
04	6.00	4.00	10.00
05	8.00	6.00	12.00
06	10.00	8.00	16.00
07	12.00	10.00	16.00
08	16.00	12.00	18.00
09	16.00	16.00	20.00
10	18.00	16.00	22.00
11	20.00	18.00	24.00
12	22.00	20.00	26.00
13	24.00	22.00	28.00
14	26.00	24.00	30.00
15	28.00	26.00	32.00
16	30.00	28.00	34.00

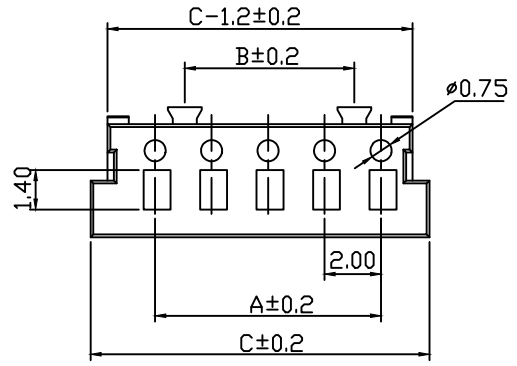
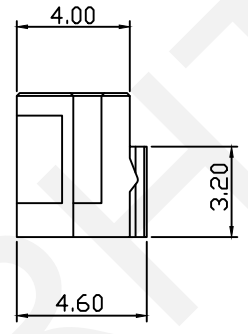
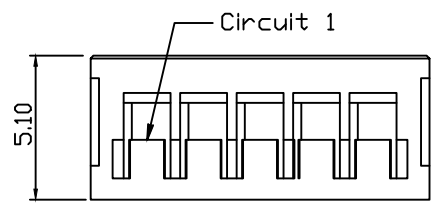

Material:
Housing:PA66 UL94V-0

Electrical Characteristics:
Rated Current : 4.0AMP
Voltage Rating: 125V AC,DC
Temperature Range: -25°C~+85°C
Insulator Resistance: 1000MΩ/Min.
Withstand Voltage: 1000V AC/DC
Contact Resistance: 10MΩ/Max

Order Information

RHTAYC1-2.0-XX-H

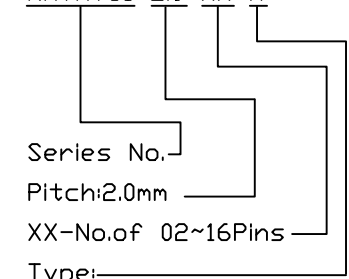

Type: _____
T-Terminal H-Hosing
S-Straight Male Pin
R-Right Angle Male Pin

RHTECP NINGBO RHT ELECTRONIC CO.,LTD

UNITS:mm	SHEET SIZE: A4				SCALE:---	DRWN BY PAN
0~3	3~18	18~50	50~120	CHK'D BY FENG	2.0mm Pitch 179228 292130 Wire to Board Connector	
±0.12	±0.15	±0.3	±0.5	APPR BY ZHAN	THIRD ANGLE PROJECTION	RHTAYC1-2.0-XX-H

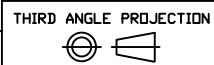

RoHS Compliance

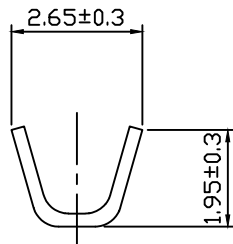
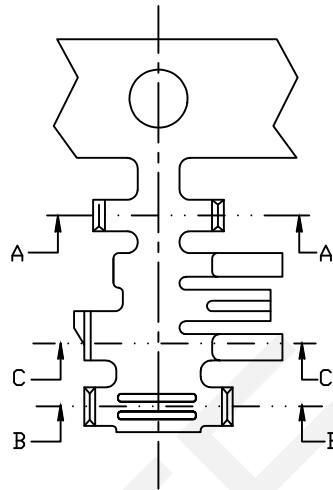
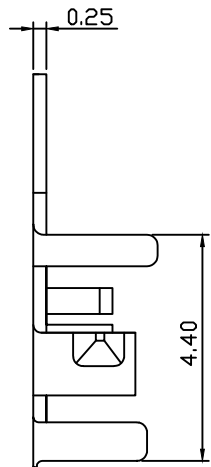

A-A

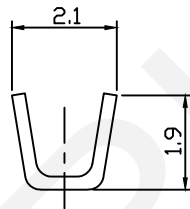

B-B

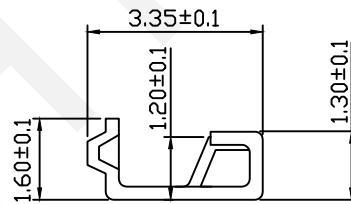

C-C

Material:

Terminal: Phosphor Bronze

Plating: Tin plated

Applicable Wires: AWG #28~#24

Insulation ϕ .D: 1.2mm Max

Electrical Characteristics:

Rated Current: 4.0AMP

Voltage Rating: 125V AC, DC

Temperature Range: -25°C~+85°C

Insulator Resistance: 1000M Ω Min

Withstand Voltage: 1000V AC/DC

Contact Resistance: 10m Ω Max

Order Information

RHTAYC1-2.0-T

Series No. _____

Pitch: 2.00mm

Type: _____

H-Hosing T-Terminal

S-Straight Male Pin

R-Right Angle Male Pin

RHTECP NINGBO RHT ELECTRONIC CO.,LTD

UNITS:mm	SHEET SIZE: A4	SCALE:----	DRWN BY PAN
0~3	3~18	18~50	50~120
±0.12	±0.15	±0.3	±0.5

CHK'D BY FENG
APPR BY ZHAN

2.0mm Pitch 179228 292130
Wire to Board Connector
THIRD ANGLE PROJECTION
 RHTAYC1-2.0-T

RoHS Compliance

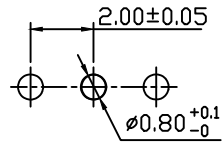
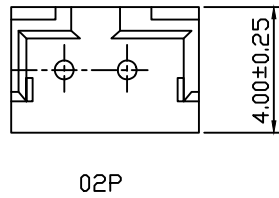
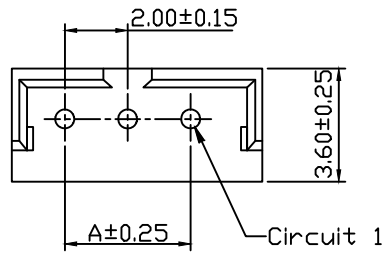

Recommended PCB Layout

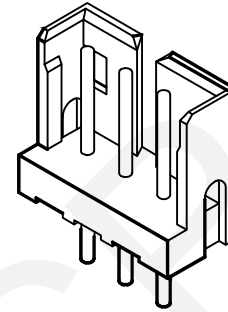

Material:
Housing:PA66 UL94V-0
Contact:Brass
Rating:Tin Rated

Electrical Characteristics:
Rated Current : 4.0AMP
Voltage Rating: 125V AC,DC
Temperature Range: -25°C~+85°C
Insulator Resistance: 1000MΩ/Min.
Withstand Voltage: 1000V AC/DC
Contact Resistance: 10MΩ/Max

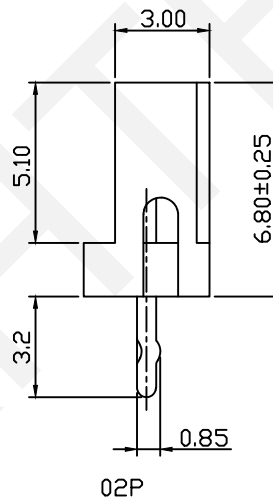
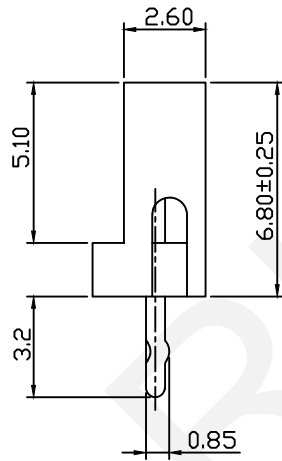
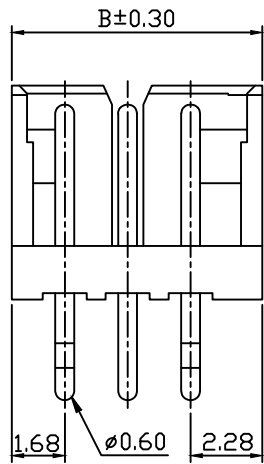

Pin	Dimension(mm)	
	A	B
02	2.00	5.96
03	4.00	7.96
04	6.00	9.96
05	8.00	11.96
06	10.00	13.96
07	12.00	15.96
08	16.00	17.96
09	16.00	19.96
10	18.00	21.96
11	20.00	23.96
12	22.00	25.96
13	24.00	27.96
14	26.00	29.96
15	28.00	31.96

Order Information

RHTAYC1-2.0-XX-S

Series No. _____
Pitch:2.0mm _____
XX-No.of 02~15Pins _____
Type: _____
T-Terminal H-Hosing
S-Straight Male Pin
R-Right Angle Male Pin

RHTECP NINGBO RHT ELECTRONIC CO.,LTD

UNITS:mm SHEET SIZE: A4 SCALE:--- DRWN BY PAN
0~3 3~18 18~50 50~120 CHK'D BY FENG
±0.12 ±0.15 ±0.3 ±0.5 APPR BY ZHAN

2.0mm Pitch 179228 292130
Wire to Board Connector
THIRD ANGLE PROJECTION
RHTAYC1-2.0-XX-S

RoHS Compliance

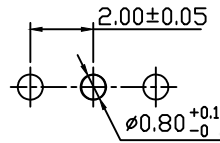
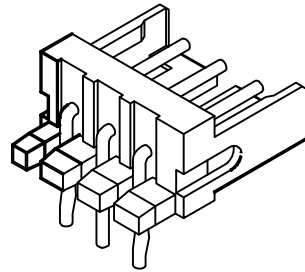
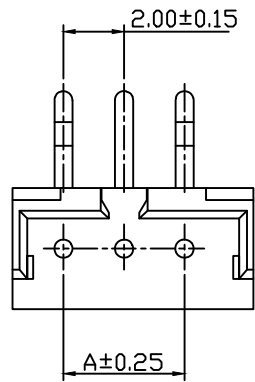

Recommended PCB Layout

Material:
Housing:PA66 UL94V-0
Contact:Brass

Electrical Characteristics:
Rated Current : 4.0AMP
Voltage Rating: 125V AC,DC
Temperature Range: -25°C~+85°C
Insulator Resistance: 1000MΩ/Min.
Withstand Voltage: 1000V AC/DC
Contact Resistance: 20MΩ/Max

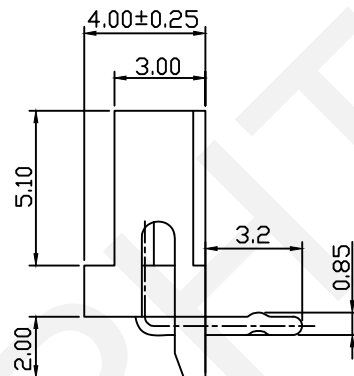
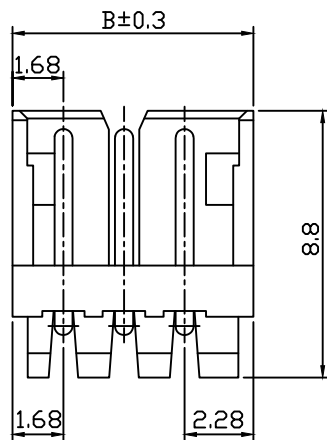

Pin	Dimension(mm)	
	A	B
02	2.00	5.96
03	4.00	7.96
04	6.00	9.96
05	8.00	11.96
06	10.00	13.96
07	12.00	15.96
08	16.00	17.96
09	16.00	19.96
10	18.00	21.96
11	20.00	23.96
12	22.00	25.96
13	24.00	27.96
14	26.00	29.96
15	28.00	31.96

Order Information

RHTAYC1-2.0-XX-R

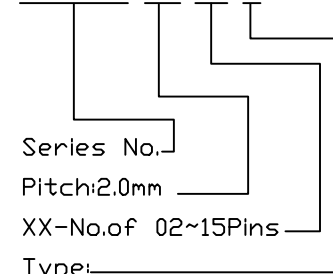

Type:
T-Terminal H-Hosing
S-Straight Male Pin
R-Right Angle Male Pin

RHTECP NINGBO RHT ELECTRONIC CO.,LTD

UNITS:mm	SHEET SIZE: A4				SCALE:---	DRWN BY PAN
0~3	3~18	18~50	50~120	CHK'D BY FENG	2.0mm Pitch 179228 292130 Wire to Board Connector	
±0.12	±0.15	±0.3	±0.5	APPR BY ZHAN	THIRD ANGLE PROJECTION	RHTAYC1-2.0-XX-R

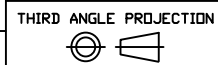

THIRD ANGLE PROJECTION

RHTAYC1-2.0-XX-R